

# All In One Pos Terminal 8-Core Android12 3.8V 6400aAh Handheld Pos System With 58mm Thermal Printer

Our Product Introduction

for more products please visit us on [hanbutech.com](http://hanbutech.com)

## Basic Information

- Place of Origin: GUANGDONG
- Brand Name: Hanbu
- Certification: CE,ROHS
- Model Number: P6
- Minimum Order Quantity: 1
- Delivery Time: 5-7days

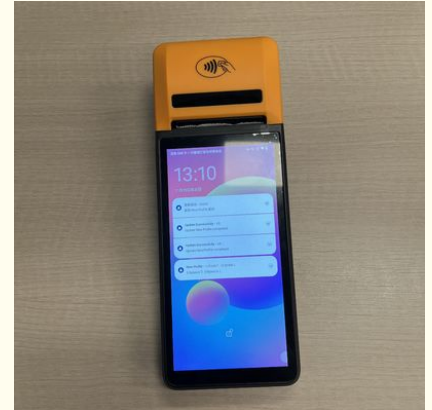

## Product Specification

- Touch Screen: Capacities Five-Point Touch
- Battery Capacity (mAh): 3.8V 6400aAh (7.6V 3200mAh)
- Operating System: Android12/13
- Memory: 3G Or 4G
- Processor: 8-Core \* 1.6GHz
- Screen Size: 5.99"
- Physical Button: Power Button \*1, Vol +/- \*1 Scan \*1
- Printer Output Type: 58mm Thermal Paper
- Highlight: **Android 12 Pos Terminal, 8-Core Pos Terminal, 58mm Thermal Printer Pos Terminal**

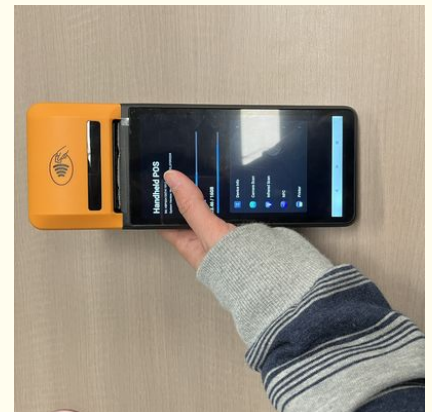

## More Images

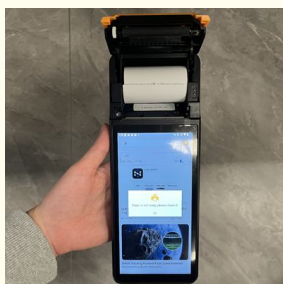

### Product Description:

One of the standout features of our Android handheld POS terminal is its physical buttons. With a power button, vol+/- button, and scan button, you can easily navigate the device and complete transactions quickly and efficiently. The device runs on Android12/13, ensuring that you have access to the latest technology and features.

In terms of storage, our Android POS machine comes with either 16GB or 64GB of internal storage, depending on your needs. This is more than enough space to store transaction data and other important information. Additionally, the device has a battery capacity of 3.8V 6400mAh (7.6V 3200mAh), so you can use it for extended periods of time without worrying about running out of power.

### Features:

Product Name: Handheld Pos

Memory: 3G Or 4G

Printer output type: 58mm Thermal Paper

Battery capacity (mAh): 3.8V 6400mAh (7.6V 3200mAh)

Connection method: Usb, Bluetooth, NFC, Wifi, 4G

Operating System: Android12/13

This Handheld Pos is an Android POS System with a 6 inch pos display, ideal for use as a Cash POS Machine. It has 3G or 4G memory, a 58mm Thermal Paper printer output type, and a battery capacity of 3.8V 6400mAh (7.6V 3200mAh). It can be connected via Usb, Bluetooth, NFC, Wifi, or 4G and runs on the Android12/13 operating system.

### Technical Parameters:

Technical Parameter	Description
Product Name	Handheld POS Machine
Touch Screen	Capacitive Five-Point Touch
Color	Black/Orange/Blue/Purple
Connection Method	USB, Bluetooth, NFC, WiFi, 4G
Physical Button	Power Button *1, Vol +/- *1, Scan *1
Screen Size	5.99"
Operating System	Android 12/13
Battery Capacity (mAh)	3.8V 6400mAh (7.6V 3200mAh)
Storage	16GB or 64GB
Printer Output Type	58mm Thermal Paper
Memory	3GB or 4GB
Additional Features	All In One POS

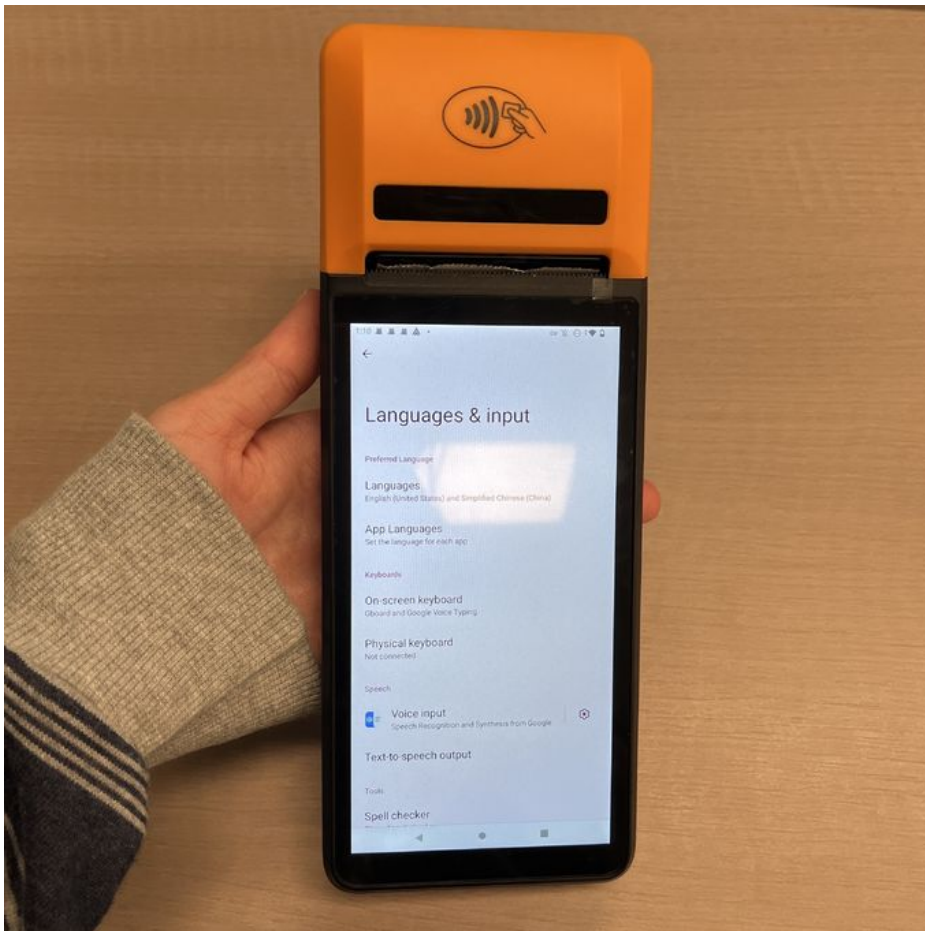

### Applications:

The Hanbu P6 is a 6 inch pos device with a capacitive five-point touch screen, making it easy to navigate and use. It's powered by a 3.8V 6400mAh (or 7.6V 3200mAh) battery, providing plenty of power to keep you running all day. Plus, with dual SIM slots, you can stay connected no matter where you are.

One of the key features of the Hanbu P6 is its powerful Android12/13 operating system. This allows you to run a wide range of apps and software, making it easy to customize your POS system to meet your specific needs. Whether you're running a restaurant, retail store, or any other type of business, the Hanbu P6 is the perfect solution.

The Hanbu P6 also comes with either 16G or 64G of storage, giving you plenty of space to store all of your important data and software. And with CE and ROHS certification, you can be sure that this device meets the highest standards of quality and safety.

Whether you're looking for a new Android POS Machine for your business or simply need a reliable handheld POS device for on-the-go transactions, the Hanbu P6 is the perfect choice. With a minimum order quantity of just one and delivery time of 5-7 days, it's never been easier to get your hands on this powerful and versatile device.

### Customization:

### Support and Services:

Our Handheld Pos product is backed by a comprehensive technical support and service program, aimed at providing our customers with timely and effective resolutions to any issues they may encounter. Our technical support team is available to assist with installation, configuration, and troubleshooting of the Handheld Pos product.

In addition to technical support, we also offer a range of services to help our customers get the most out of their Handheld Pos product. These services include training, consulting, and customization, all designed to meet the unique needs of each customer.

Our commitment to excellent support and service ensures that our customers can rely on the Handheld Pos product to deliver the performance and functionality they need to successfully run their business.

### Packing and Shipping:

#### Product Packaging:

The handheld POS device will be carefully packaged in a sturdy cardboard box with protective foam inserts to prevent any damage during transit. The device will be wrapped securely in bubble wrap to ensure that it does not move around during shipping.

#### Shipping:

The handheld POS device will be shipped via a reputable courier service to ensure that it arrives at its destination in a timely and secure manner. Shipping costs will be calculated based on the destination and delivery timeframe chosen by the customer. Once the device has been shipped, the customer will receive a tracking number so they can monitor the progress of their order.

### FAQ:

Q: What is the brand name of this handheld Pos?

A: The brand name of this handheld Pos is Hanbu.  
Q: What is the model number of this handheld Pos?  
A: The model number of this handheld Pos is P6.  
Q: What is the place of origin of this handheld Pos?  
A: The place of origin of this handheld Pos is GUANGDONG.  
Q: What certifications does this handheld Pos have?  
A: This handheld Pos is certified with CE and ROHS.  
Q: What is the minimum order quantity for this handheld Pos?  
A: The minimum order quantity for this handheld Pos is 1.  
Q: What is the delivery time for this handheld Pos?  
A: The delivery time for this handheld Pos is 5-7 days.



**Guangzhou Hanbu Information Technology Co., Ltd.**



15790408050



jennychen@hanbuiot.com



hanbutech.com

Unit A, 3rd Floor, Building C, No. 16 Shaobai Road, Xintang Town